



Medium Velocity Nozzle

INTRODUCTION

The Medium Velocity waterspray Nozzle is an open (non-automatic) nozzle, designed to produce a solid cone of water. The deflector plate will discharge a uniform filled cone of medium velocity water droplets.

TECHNICAL DATA

- Maximum working pressure : 20 Bar
- Maximum pressure test pressure : 30 Bar
- Design pressure : 1,4 to 4,1 Bar

MATERIAL

- Titanium : Approved Titanium gr2 According to M650
- SS316 : Stainless steel type : SS316
- Duplex : Duplex steel
- Super Duplex : Super Duplex steel
- LG2 : Bronze LG2
- NiAlBr : Nickel Aluminum Bronze





◀ Medium Velocity Nozzle

INSTALLATION

The nozzle must be unpacked and handled with care to avoid any damage prior to installation. Visibly damaged nozzles must not be installed. Apply sealant as required based on the nozzle thread designation, and follow torque specifications from standard handbooks or local authority regulations, considering the nozzle's material and dimensions. Ensure the nozzle is properly installed into the pipe fitting. When available, it is recommended to use the Fireproducts Nozzle Wrench FP-N-MV-W to prevent damage during installation. Avoid excessive tightening, as this can cause significant damage to the nozzle and deflector, potentially affecting the spray pattern and overall performance. The nozzle must be free from contaminants such as residue or particles that could lead to blockage or malfunction.

MAINTENANCE

The system owner is solely responsible for maintaining the water spray system and its components to ensure proper performance when required. Regular inspections and cleaning should be conducted to prevent build-up or degradation that could impair nozzle functionality. Maintenance practices must align with manufacturer guidelines and local regulations to guarantee reliability during system activation.

RECOMMENDED WORKING PRESSURE

Min. 1,4 Bar // 20 PSI Max 4,1Bar // 60 PSI



Fireproducts



◀ Medium Velocity Nozzle

ORDERING INFORMATION

The ordering code is built up according to the following:

FP-N-MV-01-02-03-04

- FP Fireproducts
- N Main category : Nozzle
- MV Medium Velocity

01 K-FACTOR (METRIC)

- 17
- 23
- 32
- 41
- 63
- 78
- 81
- Other K-factor upon request

02 SPRAY ANGLE

- 60
- 90
- 100
- 120
- Other spray angle upon request

03 MATERIAL

- TI Titanium gr2
- SS316 Stainless steel type SS316
- DU Duplex steel
- SD Super Duplex steel
- LG2 Bronze
- NiAlBr Nickel Aluminum Bronze

04 CONNECTION TYPE

- 1/2"NPTM Thread NPTM
- 1/2"BSPM Thread BSPM





◀ Medium Velocity Nozzle

TECHNICAL DRAWINGS

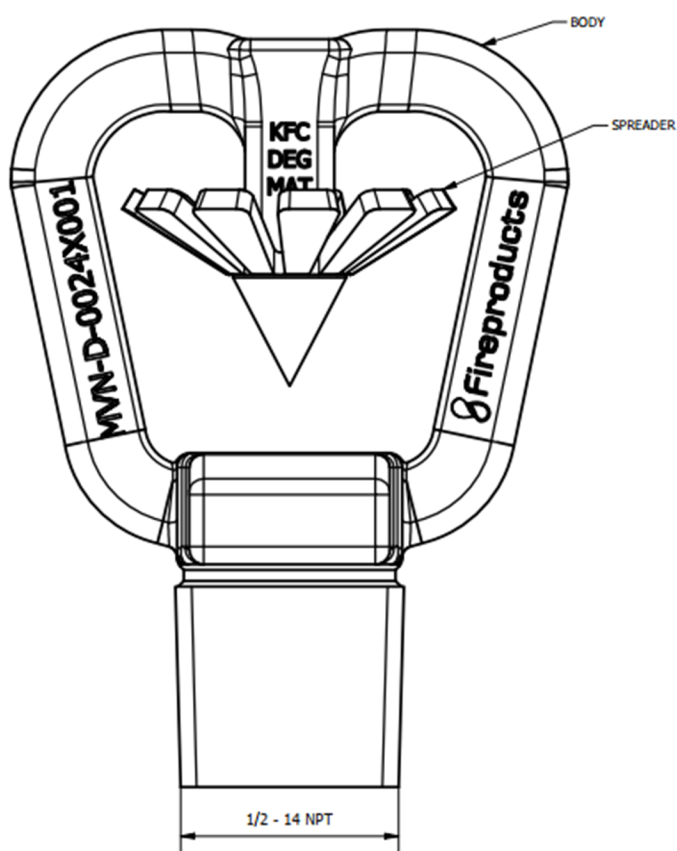
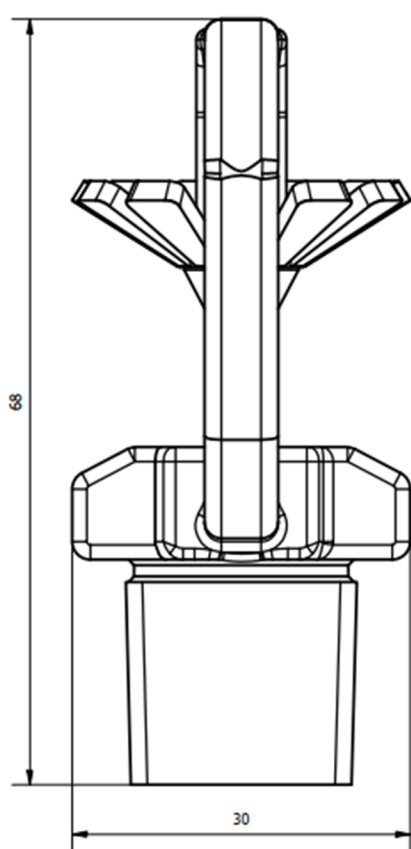

Fireproducts

Fireproducts AS
Holskogveien 48
4624 Kristiansand, Norway

Office +47 99 09 73 00
E-mail sales@fireproducts.no

www.fireproducts.no